

DPS Series Din-rail Power Supplies

Motion Control Products introduce our new DPS series regulated, single output industrial DIN Rail power supply, featured with short circuit, overload and over voltage protection. It can be installed on DIN Rail TS-35/7.5 or 15 and offers cooling by free air convection.

FEATURES

- Isolation Class II
- Protection: Short circuit, overload, over-voltage
- Can be installed on DIN rail TS-35/7.5 or 15
- LED indicator for power on
- 100% full load burn-in test
- 2 years warranty
- CE marked/ certified



TECHNICAL SPECIFICATIONS

Model		DPS100-12	DPS100-24
Output	DC Voltage	12V	24V
	Rated Current	8A	4.2A
	Current Range	0~8A	0~4.2A
	Rated Power	100W	100W
	Ripple & Noise	120 mVp-p	150 mVp-p
	Voltage Adj. Range	11-15V	21.6-29.0V
	Hold Up Time	100ms/230VAC	
Set up, Rise time		500ms, 20ms / 230VAC	
Input	Voltage Range	170-265 VAC 47~63Hz	
	Efficiency	87%	88%
	Ac Current	0.75A/230VAC	
	Inrush Current	Cold Start <50A at 230VAC	
Protection	Over Current	110~130% rated output power	
	Protection Type	Hiccup mode, recovers automatically after fault condition is removed	
	Over Voltage	Hiccup mode, recovers automatically after fault condition is removed	
Environment	Working Temp & Humidity	-20-60°C	20-90% RH
	Storage Temp & Humidity	-40-80°C	10-90%RH
Safety & EMC	Safety Standards	Design Refer to: EN60950	
	Withstand Voltage	I/P-O/P:3KVAC	
	Isolation Resistance	I/P-O/P:>100M Ohms / 500VDC	
	EMC Emission	Compliance to EN55022 , EN61000-3-2 ,	
	EMC Immunity	Compliance to EN55024, EN61000-3-3,	
Others	Dimension	100*97*56mm (W*H*D)	
	Packing	0.32kg/pc, 30pcs, 10.18kg/ctn	

MECHANICAL DIMENSIONS

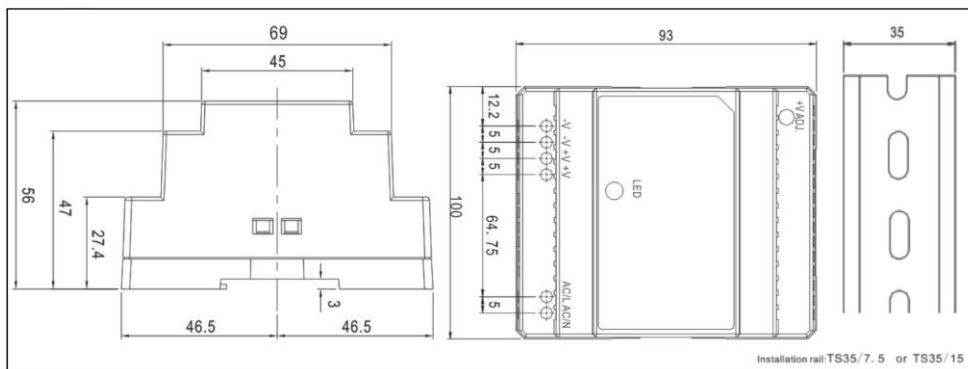

Copyright © 2015 Motion Control Products Ltd.
All rights reserved. All data subject to change without notice in advance